

# SERIES CP (Paving Chairs)

Post-tension cable and rebar



## CP 4"

### PRODUCT DESCRIPTION

Pyramidal chairs for post-tension cable and rebar, designed to keep the cable or rebar in the required position according to the structural calculation. Horizontal chair that guarantees great stability

### SPECIFICATIONS

- Compressive strength 550 lb/in<sup>2</sup> (determined by means of a presfor quality control in the factory). This load is considered for the distribution of pieces in the area to be fitted.
- Pieces made of 100% post-industrial polypropylene, under injection process.
- 100% waterproof and inert product; does not react with the concrete and prevents cracks
- Optimal operation under extreme temperatures (-23°f to 131°f)

### Technical information



#### installation instructions

from 0.60yd to 1.00yd. An approximate  
The separation between saddles can be  
average of 3 pieces per yd<sup>2</sup>

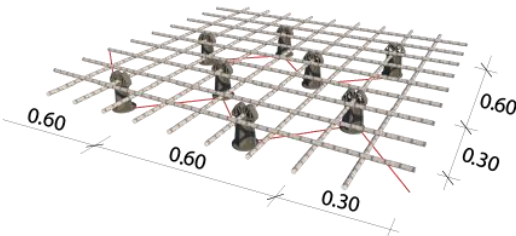

#### Transport and storage

You must protect the product from the sun  
and rain.



#### ORDER INFORMATION

Reference:	CP 4"
Height to fit (in):	4
Steel gauge:	Up to #5 (5/8")
Units per package:	250
Bags per pallet	52
Units per pallet	13,000
weight per piece (lb)	0.0639
weight per package (lb)	16

# SERIES CP (Paving Chairs)

Post-tension cable and rebar



## CP 4.5"

### PRODUCT DESCRIPTION

Pyramidal chairs for post-tension cable and rebar, designed to keep the cable or rebar in the required position according to the structural calculation. Horizontal chair that guarantees great stability

### SPECIFICATIONS

- Compressive strength 550 lb/in<sup>2</sup> (determined by means of a presfor quality control in the factory). This load is considered for the distribution of pieces in the area to be fitted.
- Pieces made of 100% post-industrial polypropylene, under injection process.
- 100% waterproof and inert product; does not react with the concrete and prevents cracks
- Optimal operation under extreme temperatures (-23°f to 131°f)

### Technical information

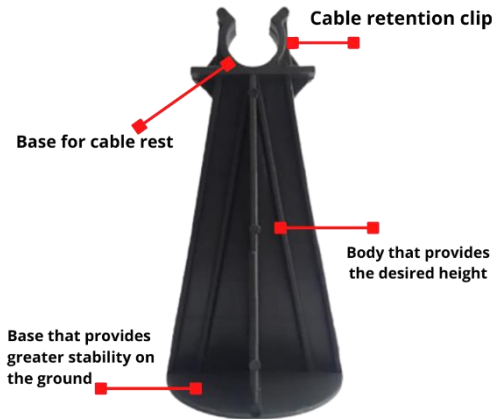

### installation instructions

from 0.60yd to 1.00yd. An approximate  
The separation between saddles can be  
average of 3 pieces per yd<sup>2</sup>

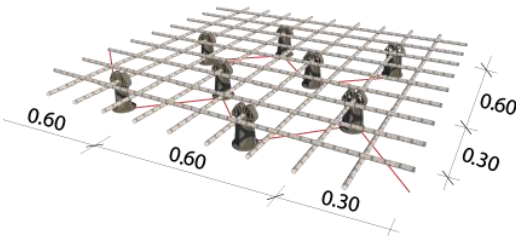

### Transport and storage

You must protect the product from the sun  
and rain.



### ORDER INFORMATION

Reference:	CP 4.5"
Height to fit (in):	4.5
Steel gauge:	Up to #5 (5/8")
Units per package:	230
Bags per pallet	52
Units per pallet	11,960
weight per piece (lb)	0.0772
weight per package (lb)	18

# SERIES CP (Paving Chairs)

Post-tension cable and rebar



## CP 5"

### PRODUCT DESCRIPTION

Pyramidal chairs for post-tension cable and rebar, designed to keep the cable or rebar in the required position according to the structural calculation. Horizontal chair that guarantees great stability

### SPECIFICATIONS

- Compressive strength 550 lb/in<sup>2</sup> (determined by means of a presfor quality control in the factory). This load is considered for the distribution of pieces in the area to be fitted.
- Pieces made of 100% post-industrial polypropylene, under injection process.
- 100% waterproof and inert product; does not react with the concrete and prevents cracks
- Optimal operation under extreme temperatures (-23°f to 131°f)

### Technical information

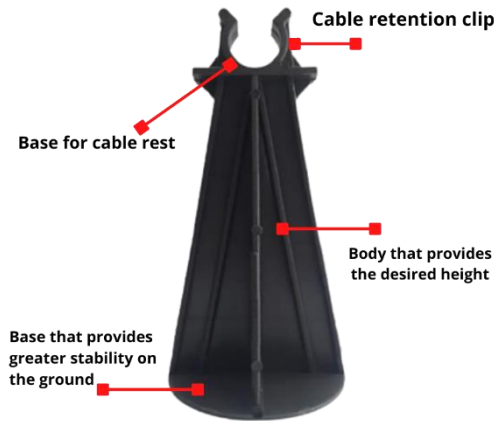

### installation instructions

from 0.60yd to 1.00yd. An approximate  
The separation between saddles can be  
average of 3 pieces per yd<sup>2</sup>

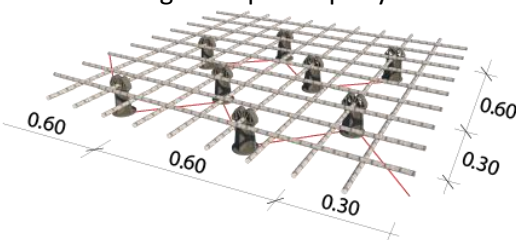

### Transport and storage

You must protect the product from the sun  
and rain.



### ORDER INFORMATION

Reference:	CP 5"
Height to fit (in):	5
Steel gauge:	Up to #5 (5/8")
Units per package:	180
Bags per pallet	48
Units per pallet	8640
weight per piece (lb)	0.01816
weight per package (lb)	15

# SERIES CP (Paving Chairs)

Post-tension cable and rebar



## CP 5.5"

### PRODUCT DESCRIPTION

Pyramidal chairs for post-tension cable and rebar, designed to keep the cable or rebar in the required position according to the structural calculation. Horizontal chair that guarantees great stability

### SPECIFICATIONS

- Compressive strength 550 lb/in<sup>2</sup> (determined by means of a presfor quality control in the factory). This load is considered for the distribution of pieces in the area to be fitted.
- Pieces made of 100% post-industrial polypropylene, under injection process.
- 100% waterproof and inert product; does not react with the concrete and prevents cracks
- Optimal operation under extreme temperatures (-23°f to 131°f)

### Technical information

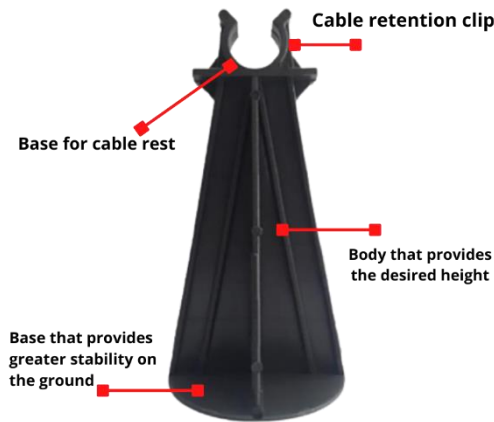

### installation instructions

from 0.60yd to 1.00yd. An approximate  
The separation between saddles can be  
average of 3 pieces per yd<sup>2</sup>

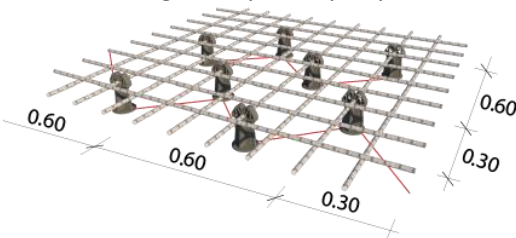

### Transport and storage

You must protect the product from the sun  
and rain.



### ORDER INFORMATION

Reference:	CP 5.5"
Height to fit (in):	5.5
Steel gauge:	Up to #5 (5/8")
Units per package:	150
Bags per pallet	48
Units per pallet	7200
weight per piece (lb)	0.1014
weight per package (lb)	15

# SERIES CP (Paving Chairs)

Post-tension cable and rebar



## CP 6"

### PRODUCT DESCRIPTION

Pyramidal chairs for post-tension cable and rebar, designed to keep the cable or rebar in the required position according to the structural calculation. Horizontal chair that guarantees great stability

### SPECIFICATIONS

- Compressive strength 550 lb/in<sup>2</sup> (determined by means of a presfor quality control in the factory). This load is considered for the distribution of pieces in the area to be fitted.
- Pieces made of 100% post-industrial polypropylene, under injection process.
- 100% waterproof and inert product; does not react with the concrete and prevents cracks
- Optimal operation under extreme temperatures (-23°f to 131°f)

### Technical information

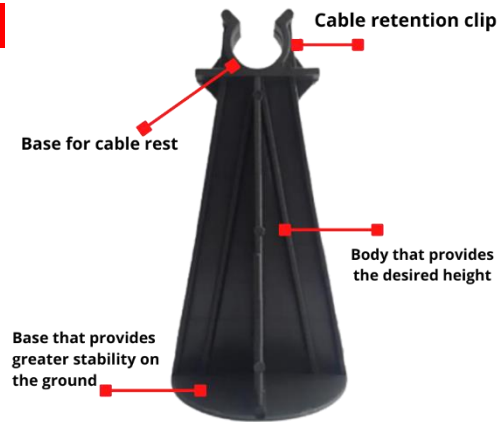

### installation instructions

from 0.60yd to 1.00yd. An approximate  
The separation between saddles can be  
average of 3 pieces per yd<sup>2</sup>

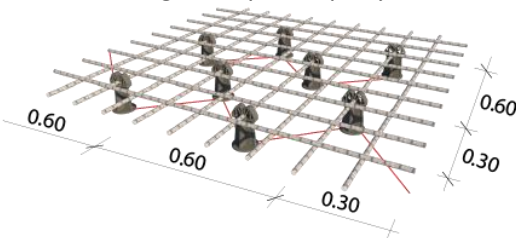

### Transport and storage

You must protect the product from the sun  
and rain.



### ORDER INFORMATION

Reference:	CP 6"
Height to fit (in):	6
Steel gauge:	Up to #5 (5/8")
Units per package:	140
Bags per pallet	44
Units per pallet	6160
weight per piece (lb)	0.1191
weight per package (lb)	17

# SERIES CP (Paving Chairs)

Post-tension cable and rebar



## CP 7"

### PRODUCT DESCRIPTION

Pyramidal chairs for post-tension cable and rebar, designed to keep the cable or rebar in the required position according to the structural calculation. Horizontal chair that guarantees great stability

### SPECIFICATIONS

- Compressive strength 550 lb/in<sup>2</sup> (determined by means of a presfor quality control in the factory). This load is considered for the distribution of pieces in the area to be fitted.
- Pieces made of 100% post-industrial polypropylene, under injection process.
- 100% waterproof and inert product; does not react with the concrete and prevents cracks
- Optimal operation under extreme temperatures (-23°f to 131°f)

### Technical information

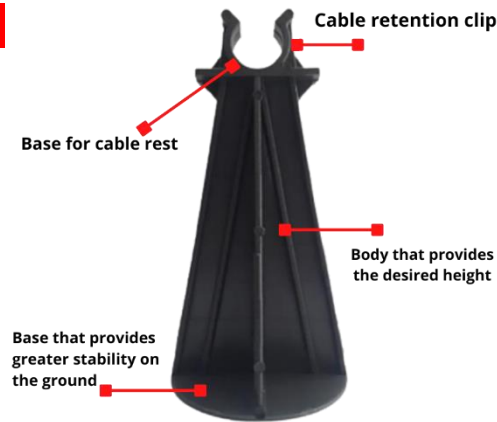

### installation instructions

from 0.60yd to 1.00yd. An approximate  
The separation between saddles can be  
average of 3 pieces per yd<sup>2</sup>

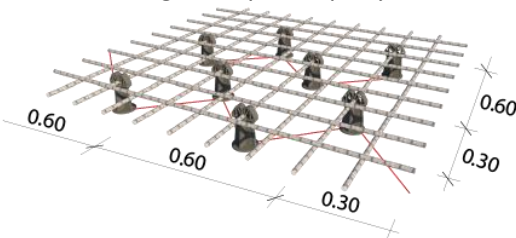

### Transport and storage

You must protect the product from the sun  
and rain.



### ORDER INFORMATION

Reference:	CP 7"
Height to fit (in):	7
Steel gauge:	Up to #5 (5/8")
Units per package:	100
Bags per pallet	44
Units per pallet	4400
weight per piece (lb)	1.01433
weight per package (lb)	14